

FOR SALE OR LEASE

3095 MARY PLACE, BLDG. F, WEST SACRAMENTO

±165,400 SF INDUSTRIAL BUILDING

SOUTHPORT BUSINESS CENTER

REPRESENTATIVE PHOTO. NOT THE ACTUAL BUILDING.



PLANNED

TODD SANFILIPPO
Senior Vice President
P: 916 781 4859
todd.sanfilippo@cbre.com
Lic. 01045162

MICHAEL LYONS
Senior Vice President
P: 916 446 8290
michael.lyons@cbre.com
Lic. 00839339

A project by
 **RIDGE CAPITAL**

CBRE

±165,400 SF AVAILABLE SOUTHPORT BUSINESS PARK

3095 MARY PLACE, BLDG. F
WEST SACRAMENTO, CA



BUILDING SPECIFICATIONS

BUILDING SF: ±165,400

DIVISIBILITY: ±40,000

OFFICE SF: (2) ±3,968

DOCK DOORS: 26

CLEAR HEIGHT: ±30'

COLUMN SPACING: ±52'x45'

BLDG DIMENSIONS: ±243'x648'

VEHICLE PARKING: 143 spaces

SLAB: 6" @ 4000 lbs psi

GRADE LEVEL: 4- ±12' x 14'

DOCK EQUIPMENT: To Suit

LIGHTING: To Suit

TRAILER PARKING: 43 spaces

CONSTRUCTION: Concrete Tilt

ELECTRICAL SERVICE: ±277/480V 3ph 4wire

SPRINKLERS: ESFR

TRUCK ACCESS: Ingress/Egress

ZONING: BP Industrial

ACRES: ±8.42

SKYLIGHTS: 1%

ROOF TYPE: Single ply, Class "A"

TPO Roof (60 ML) with white roof

20 year NDL warranty

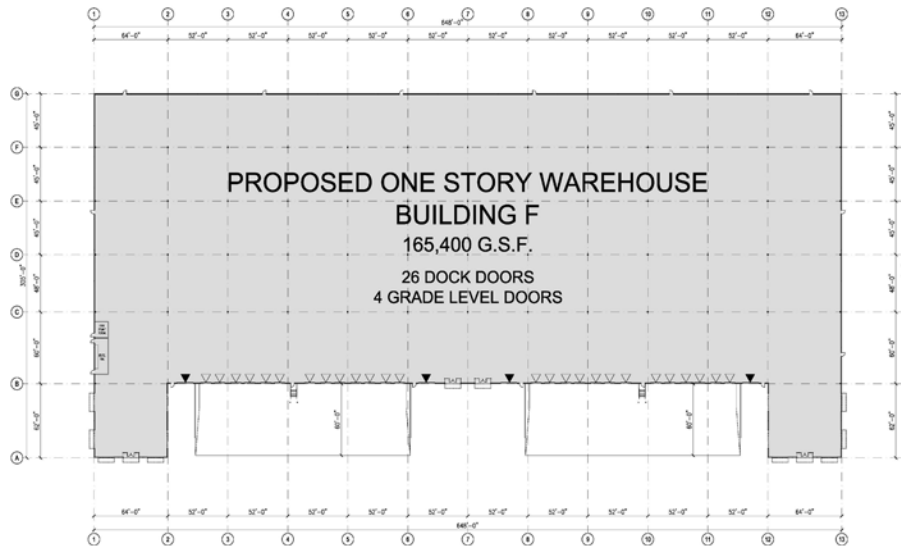

PRELIMINARY FLOOR PLAN

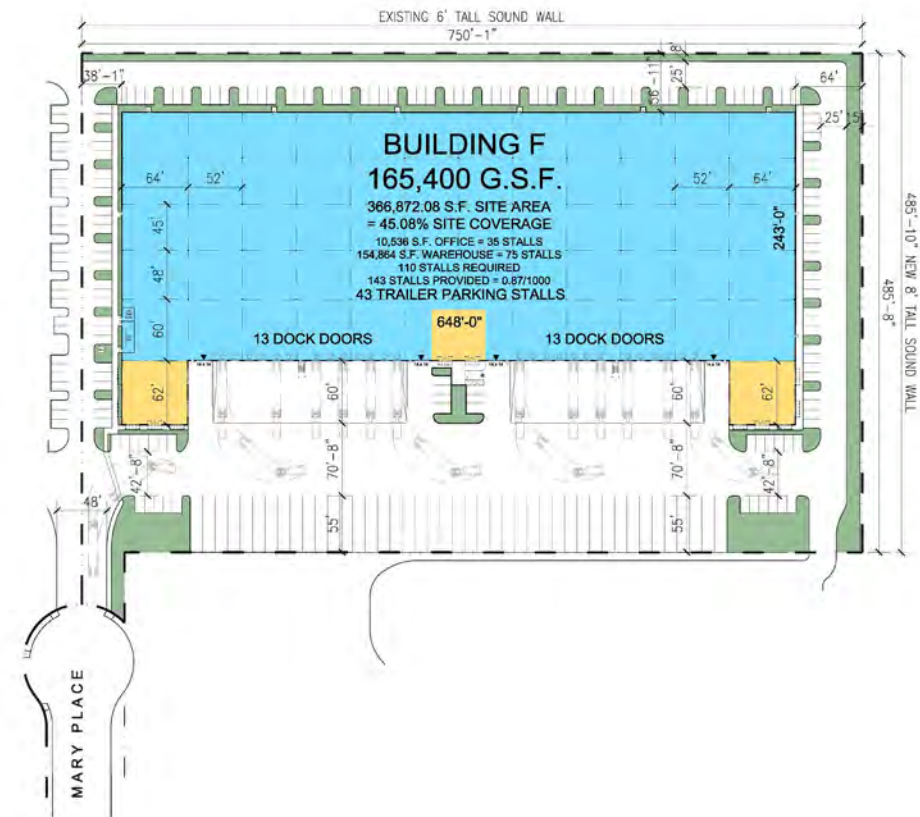

±165,400 SF AVAILABLE SOUTHPORT BUSINESS PARK

3095 MARY PLACE, BLDG. F
WEST SACRAMENTO, CA

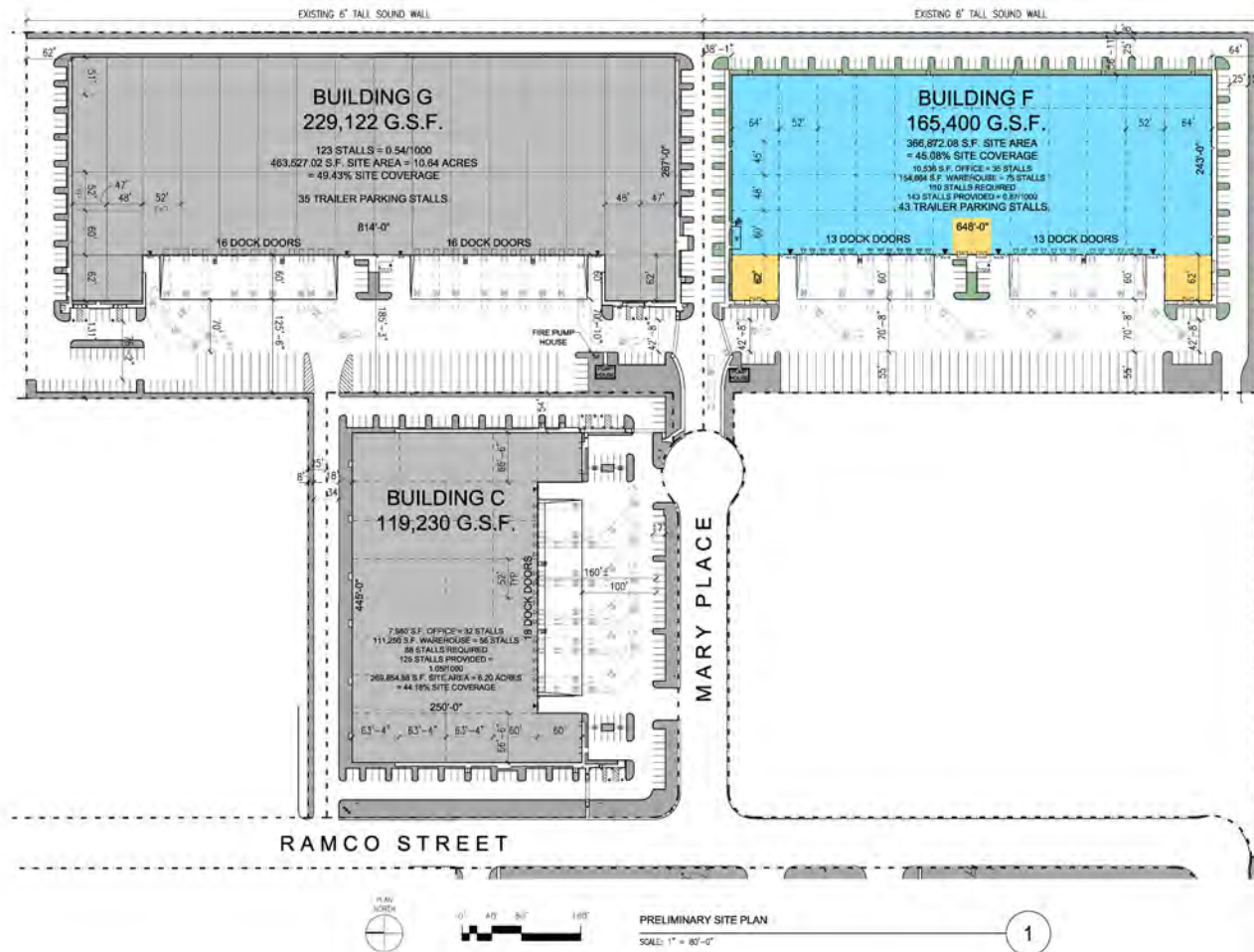

LEGEND:

- DOCK LEVEL DOOR
- GRADE LEVEL DOOR
- OFFICE AREA
- WAREHOUSE AREA



© 2020 CBRE, Inc. All rights reserved. This information has been obtained from sources believed reliable, but has not been verified for accuracy or completeness. You should conduct a careful, independent investigation of the property and verify all information. Any reliance on this information is solely at your own risk. CBRE and the CBRE logo are service marks of CBRE, Inc. All other marks displayed on this document are the property of their respective owners, and the use of such logos does not imply any affiliation with or endorsement of CBRE. Photos herein are the property of their respective owners. Use of these images without the express written consent of the owner is prohibited.

±165,400 SF AVAILABLE SOUTHPORT BUSINESS PARK

3095 MARY PLACE, BLDG. F
WEST SACRAMENTO, CA



PLANNED

**±165,400 SF AVAILABLE
SOUTHPORT BUSINESS PARK**

3095 MARY PLACE, BLDG. F
WEST SACRAMENTO, CA

 **BUILDING PHOTO**



±165,400 SF AVAILABLE SOUTHPORT BUSINESS PARK

3095 MARY PLACE, BLDG. F
WEST SACRAMENTO, CA

LOCATION & TRANSPORTATION

- I-80 interchange is ±3 miles from subject property
- I-5 interchange is ±4 miles from subject property
- Sacramento International Airport is ±15 miles from subject property
- Proximity to Distribution Hubs
 - FedEx Freight - 5.5 Miles
 - FedEx Ship Center - 16 Miles
 - FedEx Ground - 15 Miles
 - UPS Freight Service Center - 5 Miles
 - UPS Customer Center - 3 Miles
 - UPS Air Cargo - 19 Miles
 - US Post Office - 4 Miles



■ One Day Truck Service
 ■ Two Day Truck Service

Transit Analysis From Sacramento, CA

	Distance (mi.)	Time (est.)		Distance (mi.)	Time (est.)
Stockton, CA	47	→, 45 min	Salt Lake City, UT	654	9 hrs, 33 min
San Francisco	87	1 hr, 24 min	Seattle, WA	753	12 hrs, 1 min
Reno, NV	136	2 hrs, 19 min	Helena, MT	1,016	15 hrs, 25 min
Los Angeles, CA	383	5 hrs, 53 min	Cheyenne, WY	1,088	16 hrs, 15 min
San Diego, CA	509	7 hrs, 56 min	Santa Fe, NM	1,143	17 hrs, 20 min
Boise, ID	558	8 hrs, 45 min	Denver, CO	1,168	17 hrs, 50 min
Portland, OR	579	9 hrs, 7 min			



PLANNED

